

REVISIONS

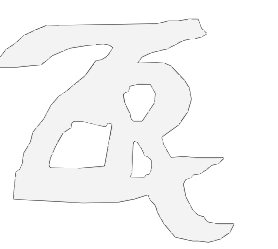

P.O. BOX 328
 NEW BERN, NC 28563
 (252) 635-6388



Zaytoun-Raines
 Construction Corporation
 312 South Front Street
 New Bern, NC 28560
 252-633-0106



FRONT ELEVATION
 1/4"=1'-0"

IT IS THE SOLE RESPONSIBILITY OF THE CONTRACTOR AND/OR BUILDER TO CONFORM TO ALL STANDARDS, PROVISIONS, REQUIREMENTS, METHODS OF CONSTRUCTION AND USES OF MATERIALS PROVIDED IN BUILDINGS AND/OR STRUCTURES AS REQUIRED BY N.C. UNIFORM BUILDING CODE, LOCAL AGENCIES AND IN ACCORDANCE WITH GOOD ENGINEERING PRACTICE. VERIFY ALL DIMENSIONS PRIOR TO CONSTRUCTION.

"THE GABRE 1"
 ELEVATION/ ROOF PLAN

© COPYRIGHT
 COASTAL
 DESIGN
 CENTER
 2003

SCALE:
 AS NOTED
 DATE:
 MARCH 2003
 FILE NAME:
 #030306
 DRAWN BY:
 S.KREWSON

SHEET
 1 OF 3

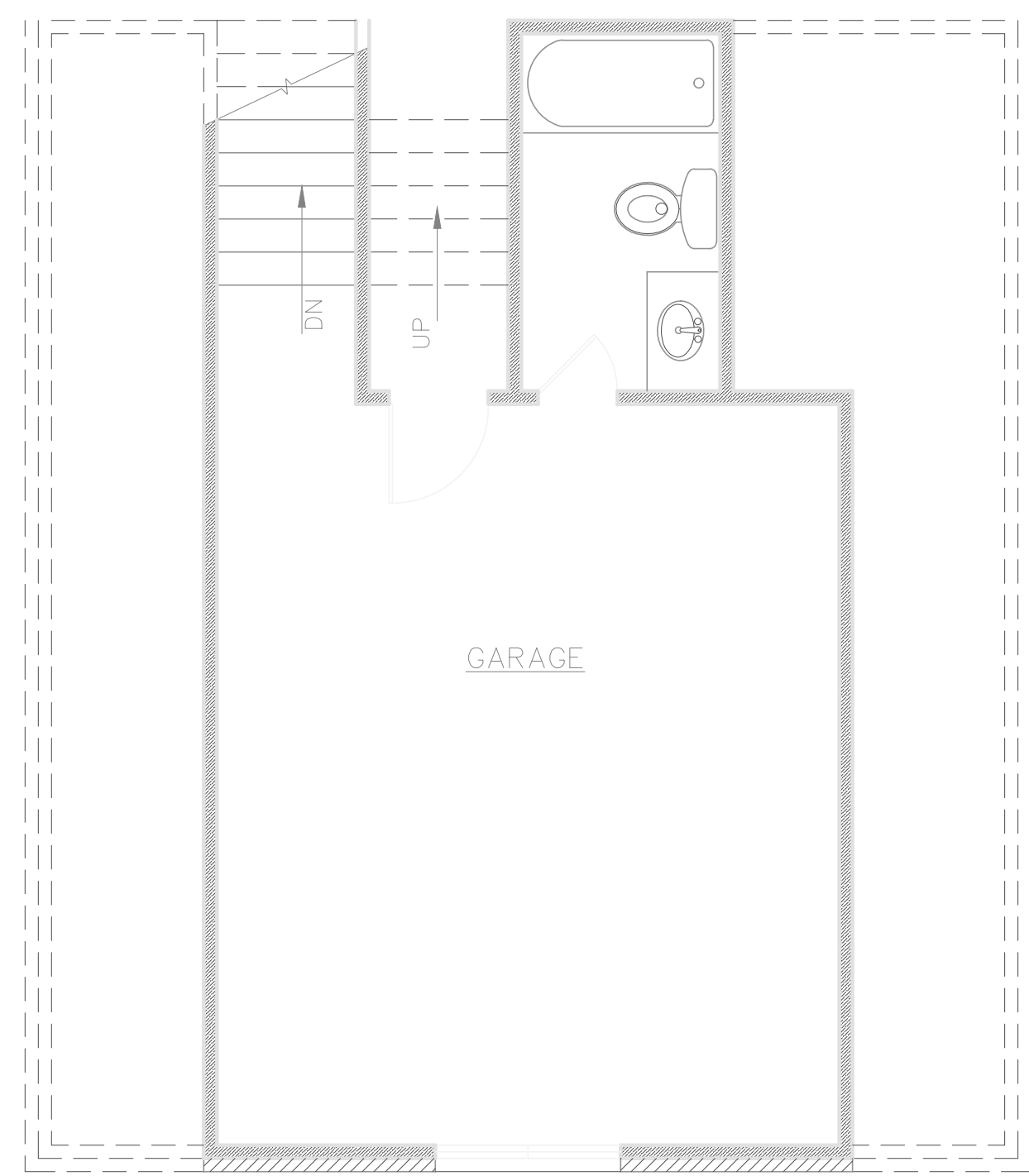

BONUS PLAN
1/4"=1'-0"

IT IS THE SOLE RESPONSIBILITY OF THE CONTRACTOR AND/OR BUILDER TO CONFORM TO ALL STANDARDS, PROVISIONS, REQUIREMENTS, METHODS OF CONSTRUCTION AND USES OF MATERIALS PROVIDED IN BUILDINGS AND/OR STRUCTURES AS REQUIRED BY N.C. UNIFORM BUILDING CODE, LOCAL AGENCIES AND IN ACCORDANCE WITH GOOD ENGINEERING PRACTICE. VERIFY ALL DIMENSIONS PRIOR TO CONSTRUCTION.

SQUARE FOOTAGE:

HEATED:	2,308'
BONUS ROOM:	380'
GARAGE:	727'
FRONT ENTRY:	31'
REAR PATIO:	189'



FLOOR PLAN
1/4"=1'-0"

REVISIONS

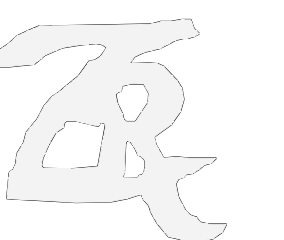

Zaytoun-Raines
 Coastal Design Center, Inc.
 312 South Front Street
 New Bern, NC 28560
 252-633-0106

"THE GABRE 1"
FLOOR PLAN

© COPYRIGHT
COASTAL
DESIGN
CENTER
2003

SCALE:
1/4"=1'-0"
DATE:
MARCH 2003
FILE NAME:
#3030306
DRAWN BY:
S.KREWSON